

Double Acting Cylinders

- Internal plunger threads
- Rod wiper seals out dirt and contamination
- High strength steel construction from gun drilled solid bar
- High flow 3/8" NPTF couplers
- Collar thread protectors
- One piece high grade alloy bearing for side load protection and long life
- Polyurethane cup seal provides for optimum performance
- Industrial hard chrome plated ram helps prevent rust and corrosion
- Solid steel cylinder body
- Ideal for pushing and pulling
- Maximum working pressure: 10,000 psi / 700 bar

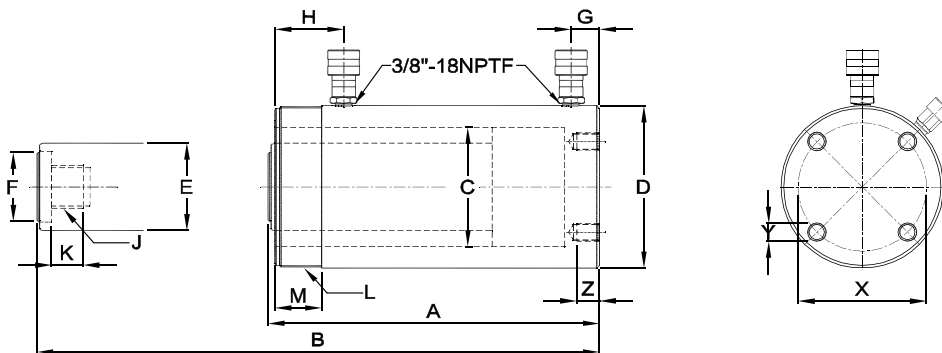

HD10018



Cylinder Capacity (tons)	Stroke (in)	Model Number	Maximum Cylinder Capacity		Cylinder Effective Area		Oil Capacity		Collapsed Height A (in)	Extended Height B (in)	Cylinder Bore Dia. C (in)	Outside Dia. D (in)
			Push (ton)	Pull (ton)	Push (in ²)	Pull (in ²)	Push (in ³)	Pull (in)				
10	10.04	HD1010	11.4	3.8	2.23	0.74	22.41	7.47	16.14	26.18	1.69	2.87
	11.97	HD1012							18.03	30.00		
30	8.15	HD3008	32.9	16.2	6.49	3.19	52.93	26.02	15.31	23.46	2.87	3.98
	14.49	HD3014							21.65	36.14		
55	6.18	HD5506	55.7	16.2	10.99	3.19	67.93	19.74	13.03	19.21	3.74	5.00
	13.19	HD5513							20.04	33.23		
	20.12	HD5520							28.86	49.98		
75	6.10	HD7506	81.7	25.9	16.09	5.12	98.1	31.21	13.70	19.80	4.53	5.75
	13.11	HD7513							20.71	33.82		
100	6.57	HD10006	104.4	48.6	20.57	9.58	135.23	62.98	14.06	20.63	5.12	6.97
	13.11	HD10013							20.63	33.74		
	18.15	HD10018							27.05	45.20		



HD10006

HD1013

HD5513

Plunger Dia.	Saddle Dia.	Base to Adv. Port	Top to Return Port	Plunger Internal Thread	Plunger Thread Length	Collar Thread	Collar Thread Length	Base Mounting Hole			Weight	Model Number
								Bolt Circle	Thread	Thread Depth		
E	F	G	H	J	K	L	M	X	Y	Z	(lbs.)	
(in)	(in)	(in)	(in)	(in)	(in)	(in)	(in)	(in)	(in)	(in)		
1.37	1.38	1.42	2.09	1"-8	0.98	2-1/4"-14	1.02	N/A			26.7	HD1010
											30.0	HD1012
2.13	1.97	1.65	2.91	1-1/2"-16	0.98	3-5/16"-12	1.93	N/A			43.0	HD3008
											60.6	HD3014
											70.5	HD5506
3.14	2.76	1.14	2.87	1"-12	0.98	5"-12	1.73	N/A			104.0	HD5513
		2.48									146.2	HD5520
3.75	2.76	1.18	2.80	1"-12"	1.50	5-3/4"-12	1.50	N/A			93.7	HD7506
											136.8	HD7513
3.75	2.95	1.22	2.95	1-3/4"-12	1.38	6-7/8"-12	1.97	5.47	3/4" -10	0.98	138.6	HD10006
		193.6									HD10013	
		248.3									HD10018	