



**CHECKBALL PISTON PUMPS
PF500 SERIES, 11 DESIGN**

PF5*-***-11**

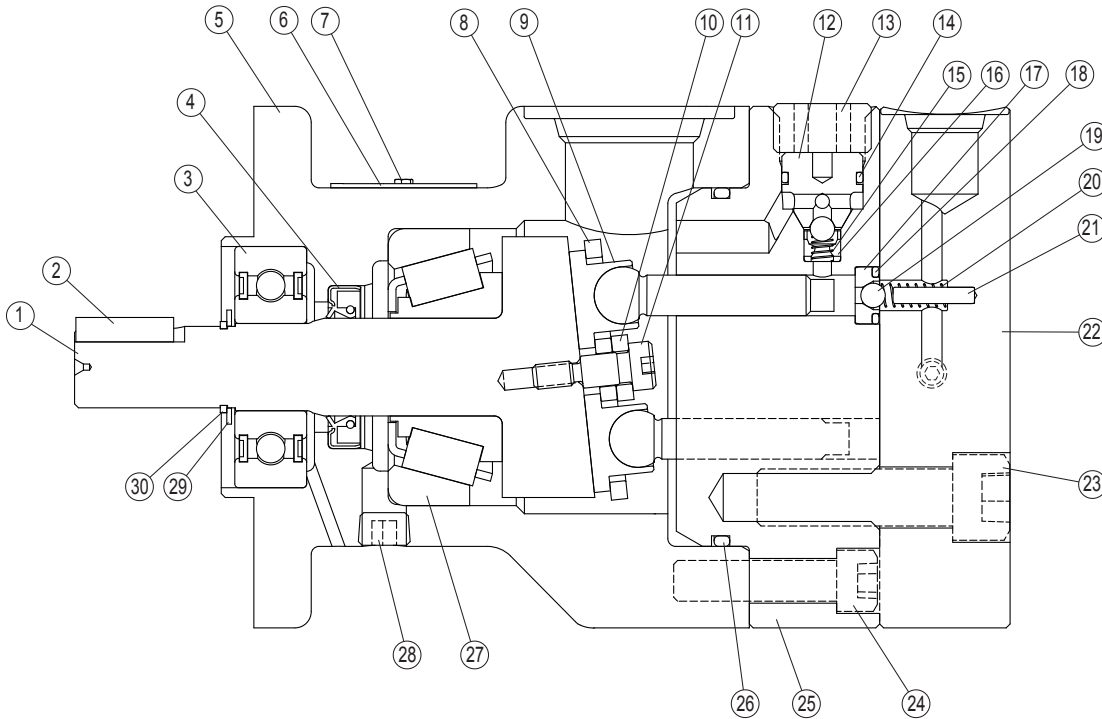

TABLE A – PARTS LIST

ID Number	Part Number	Part Description	Quantity Required
1	See Table B	Camshaft	1
2	1018.325	Key	0or1
3	1103.155	Shaft Bearing (Front)	1
4	See Table C	Shaft Seal	1
5	1218.277	Housing	1
6	1137.026	Nameplate	1
7	1001.003	Screw (Nameplate)	2
8	1448.101	Holdown Plate	1
9	See Table E	Piston Subassembly	2or4
10	1095.132	Spacer	1
11	1062.048	Shoulder Bolt ^①	1
12	1124.290	Inlet Check Seat	4
13	1577.006	Plug ^②	4
14	See Table C	O-ring (Inlet Check Seat)	4
15	See Table E	Spring (Inlet) ^③	2or4
16	See Table E	Inlet Ball Stop ^{③⑥}	2or4
17	1102.290	Outlet Check Seat	4
18	See Table C	O-ring (Outlet Check Seat)	4
19	1005.016	Checkball (Inlet/Outlet) ^⑧	6or8

ID Number	Part Number	Part Description	Quantity Required
20	1296.110	Spring (Outlet)	4
21	1123.061	Cover Pin ^⑦	4
22	See Table D	Cover	1
23	1383.028	Socket-head Capscrew ^④	4
24	1351.028	Socket-head Capscrew ^⑤	4
25	1239.050	Barrel	1
26	See Table C	O-ring	1
27	1102.155	Bearing	1
28	1007.245	Plug (Drain Port)	1
29	1156.108	Shim	1
30	1167.049	Retaining Ring	1

① Apply Loctite #271 or equivalent. Torque to 66 lb-in (7 N·m).

② Torque to 45 lb·ft (61 N·m).

③ Apply Loctite #680 or equivalent.

④ Torque to 70 lb·ft (95 N·m).

⑤ Torque to 25 lb·ft (34 N·m).

⑥ Quantity equals number of pistons. See Table E.

⑦ Pin included in Cover Assembly Kit. See Table D.

⑧ Quantity equals number of pistons +4. See Table E.

TABLE B – OUTPUT FLOW, CAMSHAFT

Output Flow Code	Cam Shaft	
	Keyed	Spline
01	1149.288	1159.288
04	1152.288	1162.288
07	1155.288	1165.288
10	1158.288	1168.288

TABLE C – SEAL KITS

Seal Code	Description	Kit Number
No Code	All Fluorocarbon (Viton® or Fluorel®) with Buna-N (Nitrile) Shaft Seal	KP05009010
XV	All Fluorocarbon (Viton® or Fluorel®) with High Pressure Shaft Seal	KP05009011
XE	All EPR with High Pressure Shaft Seal ^①	KP05009012

^① Contact the Dynex Sales department for recommended operating conditions with EPR seals.

TABLE D – PORT, COVER KITS

Port Code	Outlet Port Type	Cover Kit Number
No Code	Full Flow SAE	KP05119050
A	Full Flow Coned and Threaded	KP05119051
B	Full Flow BSPP	KP05119052
No Code	2+2 Split Flow SAE	KP05119220
A	2+2 Split Coned and Threaded	KP05119221
B	2+2 Split Flow BSPP	KP05119222
No Code	3+1 Split Flow SAE	KP05119310
A	3+1 Split Flow Coned and Threaded	KP05119311
B	3+1 Split Flow BSP	KP05119312
No Code	4x Split Flow SAE	KP051194X0
A	4x Split Coned and Threaded	KP051194X1
B	4x Split Flow BSPP	KP051194X2

TABLE E – PISTON, SEAT AND CHECK ITEMS

Item	Part Number	Description	Quantity
PF5XX(X)-XXX-XX-11			
9	3007.900	Piston Subassembly	4
15	1295.110	Spring (Inlet)	4
16	1104.290	Inlet Ball Stop	4
19	1005.016	Checkball (Inlet/Outlet)	8
PF5XX(X)-XXX-2-11 ^①			
9	3007.900	Piston Subassembly	2
15	1295.110	Spring (Inlet)	2
16	1104.290	Inlet Ball Stop	2
19	1005.016	Checkball (Inlet/Outlet)	6

^① This 2 piston pump is available in Full Flow version only.

TYPICAL MODEL CODE

PF5

01

H – S XV

A

–

22 – 1

1

Pump Type	
PF5	Fixed Displacement Checkball Pump

Output Flow (At 1800 rpm, at Rated Pressure) ^①	
01	Standard: 0.21 gpm (0,79 L/min) "H" Option: 0.20 gpm (0,75 L/min)
04	Standard: 0.34 gpm (1,28 L/min) "H" Option: 0.32 gpm (1,22 L/min)
07	Standard: 0.46 gpm (1,76 L/min) "H" Option: 0.45 gpm (1,70 L/min)
10	Standard: 0.69 gpm (2,59 L/min) "H" Option: 0.67 gpm (2,52 L/min)
① Output flows based on typical performance at rated pressure. Refer to performance curves for flows at lower pressures.	

Operating Pressure	
No Code	Standard Pressure
H	High Pressure ^①
① Requires "A" or "B" port option.	

Drive Shaft	
No Code	Keyed, 0.625 inch (15,88 mm) diameter
S	S.A.E. Spline, 0.625 inch (15,88 mm) ^①
① Contact the Dynex Sales department for availability.	

Ports	
No Code	Inlet No. 12 SAE; Outlet No. 6 SAE ^①
A	Inlet No. 12 SAE; Outlet 3/8 Medium Pressure Coned and Threaded, 0.5625-18 UNF-2B Threaded ^②
B	Inlet No. 12 SAE; Outlet G 1/4 (BSPP) ^③
① Not recommended for operation above 8000 psi (560 bar). Contact the fitting manufacturer for the pressure rating of the fitting.	
② High pressure port uses Autoclave Medium Pressure, Butech M/P or equivalent fitting.	
③ Outlet port uses British Standard Pipe Parallel fitting. Not recommended for operation above 10 000 psi (700 bar).	

Split-Flow [®] Options (4 Piston Pump) ^①	
No Code	Full flow from single outlet
Split-Flow [®] Cover Models:	
22	Two-piston output + two-piston output
31	Three-piston output + one-piston output ^②
4X	Four ports, each with one-piston output
2	Two piston output + two inactive pistons
① For outlet port sizes, locations and pump cover dimensions, contact the Dynex Sales department.	
② Port for outlet flow designated by first digit is located at the 12 o'clock position (for code "31", three-piston output flow exits the 12 o'clock port).	

Seals	
No Code	Fluorocarbon (Viton [®] or Fluorel [®]) Seals with Buna-N (Nitrile) Shaft Seal
XE	All EPR with High Pressure Shaft Seal ^①
XV	All Fluorocarbon (Viton [®] or Fluorel [®]) with High Pressure Shaft Seal
① Not available with High Pressure "H" option. Contact the Dynex Sales department for recommended operating conditions.	

Design Number

Modification Number



USA Headquarters

770 Capitol Drive
Pewaukee, WI 53072
Tel: +1 (262) 691-0300
Fax: +1 (262) 691-0312
sales@dynexhydraulics.com



Power Units & Systems

54 Nickerson Road
Ashland, MA 01721
Tel: +1 (508) 881-5110
ashland@dynexhydraulics.com



European Sales

Unit C5 Steel Close, Little End Road,
Eaton Socon, St Neots,
Cambs. PE19 8TT United Kingdom
Tel: +44 (0) 1480 213980
Fax: +44 (0) 01480 405662
sales@dynexhydraulics.co.uk



Middle East Sales

JAFZA 1, Tower A, 11th Floor
Jebel Ali Freezone
Dubai, UAE
Tel: +971 547422353
UAEsales@dynexhydraulics.com

Specifications shown were in effect when published. Since errors or omissions are possible, contact your Dynex Sales representative or the Dynex Sales department for the most current specifications before ordering. Dynex reserves the right to discontinue products or change designs at any time without incurring any obligation.

www.dynexhydraulics.com